

2

1

NOTES - UNLESS OTHERWISE SPECIFIED:

1. MATERIAL:

HOUSING:- POLYPROPYLENE (NATURAL IN COLOR)

ELEMENTS:- ACETAL (QUANTX GREEN IN COLOR)

LUER LOCK HUB:- NYLON (NATURAL IN COLOR)

2. DIMENSIONS IN mm (INCHES)

3. FINISH: CLEAN AND FREE OF MATERIAL FLASH

[9.49]  
241.05

B

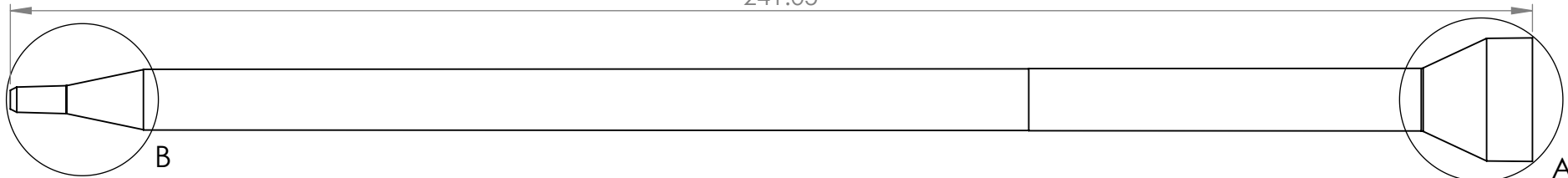

B

[0.08]  
Ø 1.93

DETAIL B  
SCALE 3 : 1

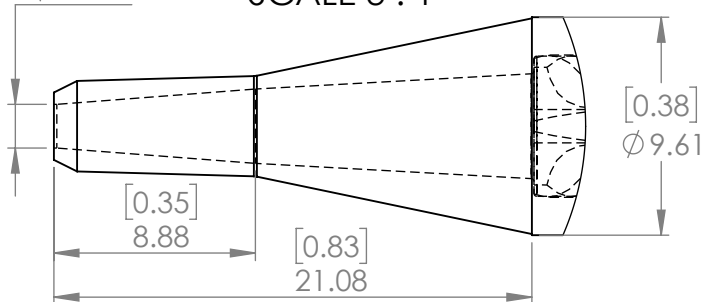

DETAIL A  
SCALE 3 : 1

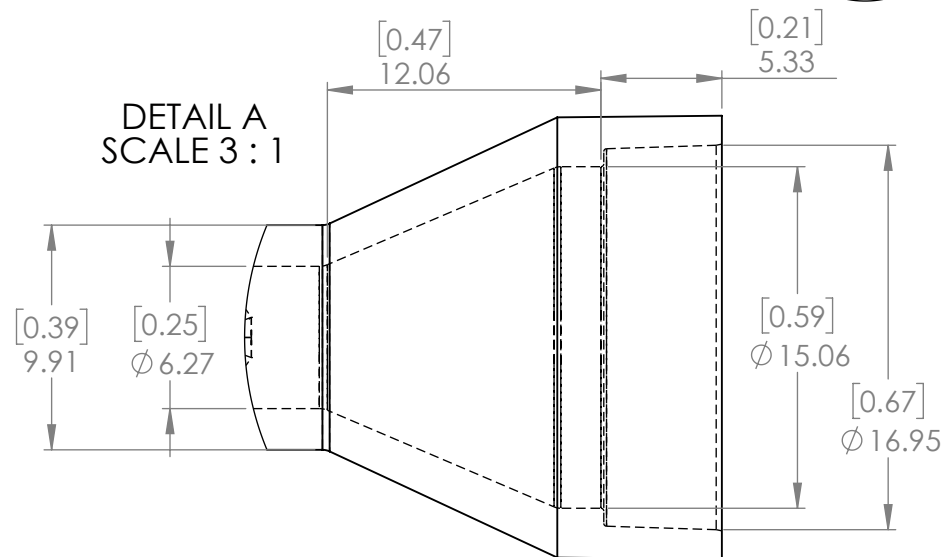

A

A

UNLESS OTHERWISE SPECIFIED:

DIMENSIONS ARE IN INCHES  
TOLERANCES:  
ANGULAR: MACH ± 1/2  
ONE PLACE DECIMAL ±.25  
TWO PLACE DECIMAL ±.13  
BREAK EDGES .15/25

INTERPRET GEOMETRIC  
TOLERANCING PER: ANSI Y14.5M

MATERIAL

SEE NOTES

DO NOT SCALE DRAWING

DRAWN

CHECKED

ENG APPR.

MFG APPR.

Q.A.

FINISH - UNLESS OTHERWISE SPECIFIED:

NAME

DATE



TITLE:

0.25" x 32 ELEMENTS  
LUER LOCK MIX NOZZLE

SIZE

A

DWG. NO.

FMCH250-32LS

REV

1

SCALE: 1:2

WEIGHT:

SHEET 2 OF 2

PROPRIETARY AND CONFIDENTIAL

THE INFORMATION CONTAINED IN THIS  
DRAWING IS THE SOLE PROPERTY OF  
FISNAR. ANY REPRODUCTION IN PART  
OR AS A WHOLE WITHOUT THE WRITTEN  
PERMISSION OF FISNAR IS PROHIBITED.

PRODUCT:

END ITEM:

NEXT ASSY:

SIMILAR TO:

APPLICATION

2

1